

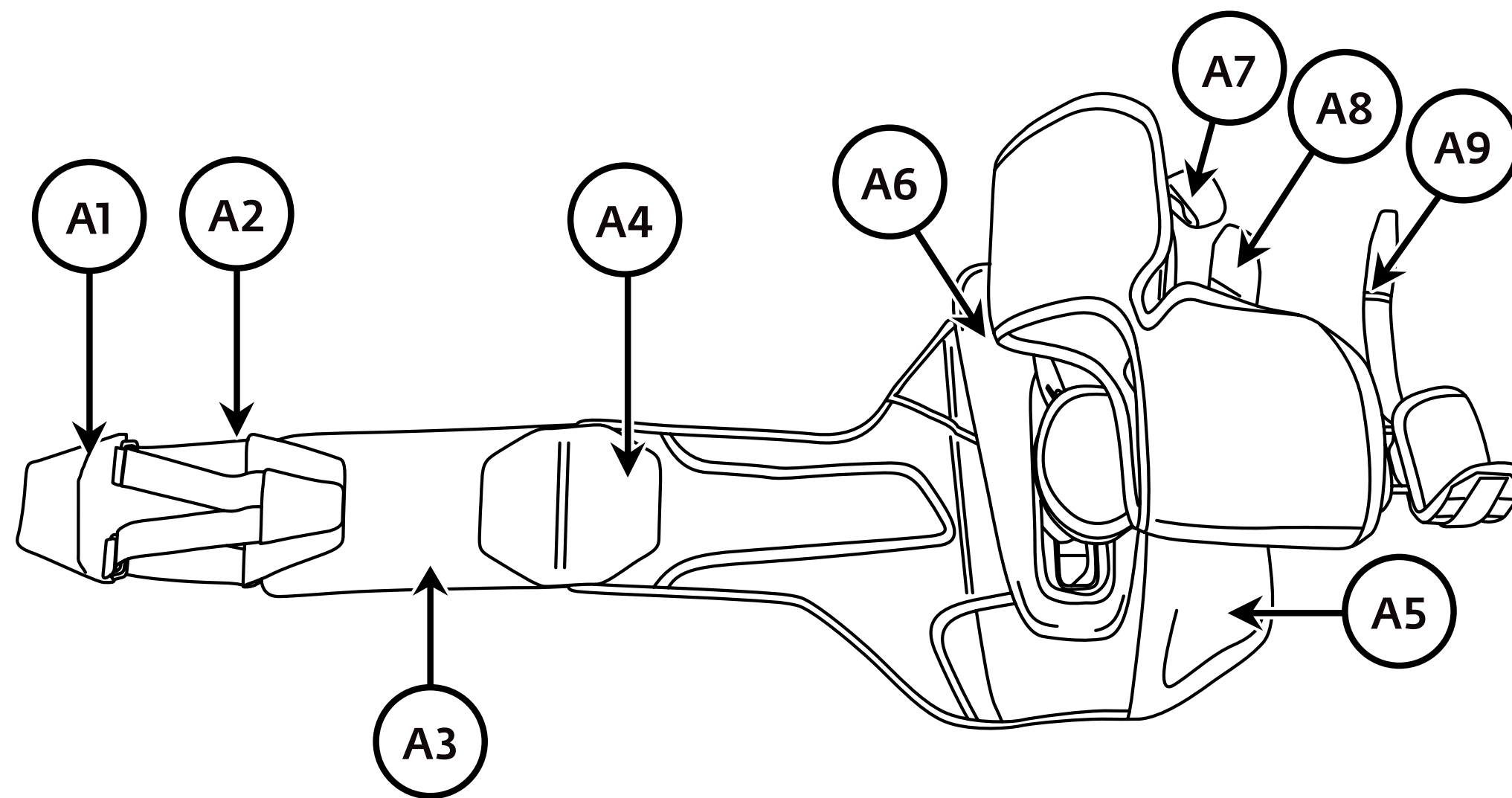

Clinician Application Instructions

Components: Waist Belt

- A1.** Belt Closure
- A2.** Belt Adjustment Strap
- A3.** Bridge Wing
- A4.** Bridge Adjustment Tab
- A5.** Front Panel



Components: Arm Brace

- A6.** Rigid Frame
- A7.** Bicep Strap
- A8.** Forearm Strap
- A9.** Hand Strap

1. –Size Waist Belt

To make Waist Belt larger, reposition Bridge Adjustment Tab on Bridge Wing.

Note: For petite patients, remove Bridge Adjustment Tab and Bridge Wing entirely.

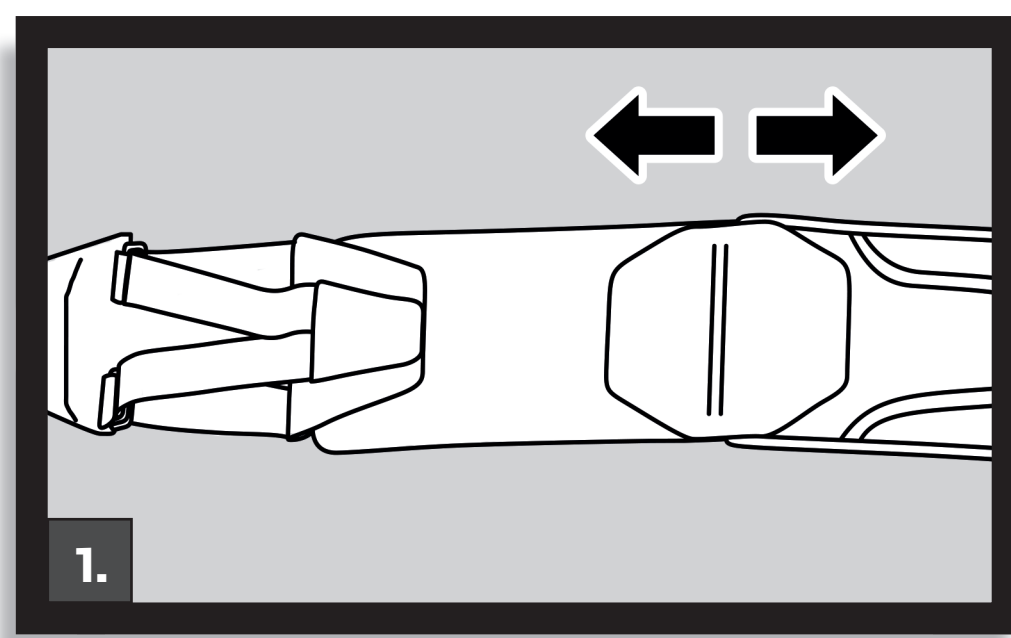

3. –Apply Brace

3a: Wrap Waist Belt around waist and attach Belt Closure Tab to Front Panel. Using Belt Adjustment Strap, pull strap across waist to tighten Waist Belt.

Note: Brace should sit approximately 1-2" above belly button and arm brace aligned with shoulder.

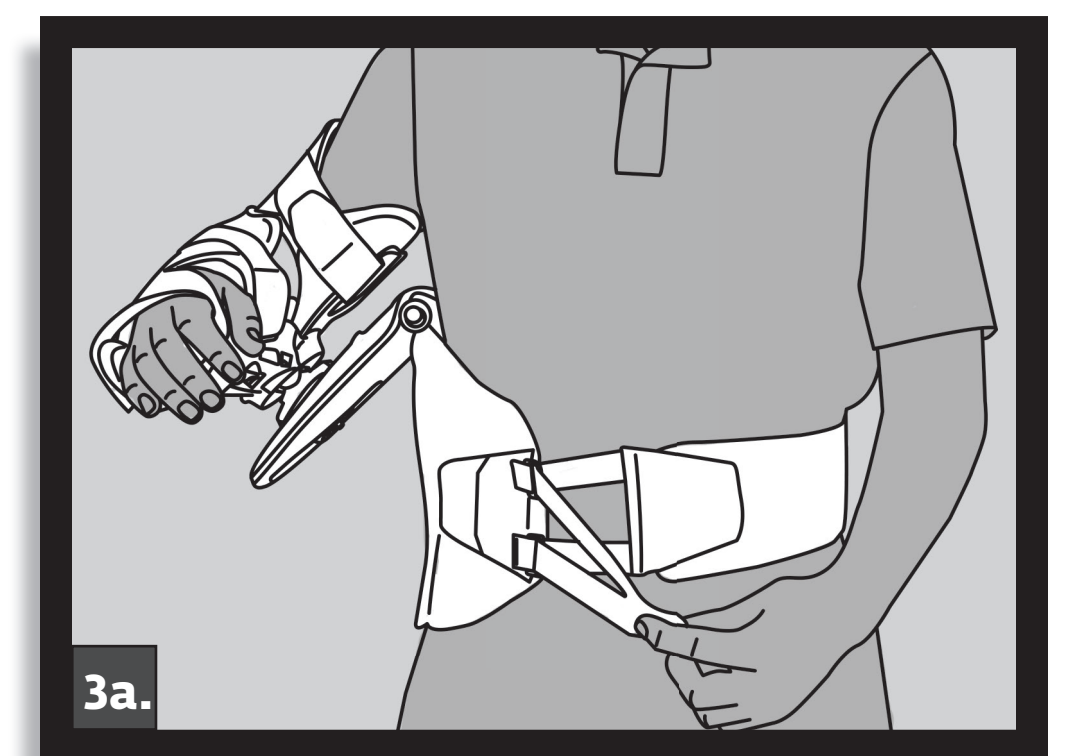

2. –Prepare the Brace

2a - AB/AD: Push in both AB Buttons. Adjust panel by 15° increments until appropriate angle is achieved. Release buttons.

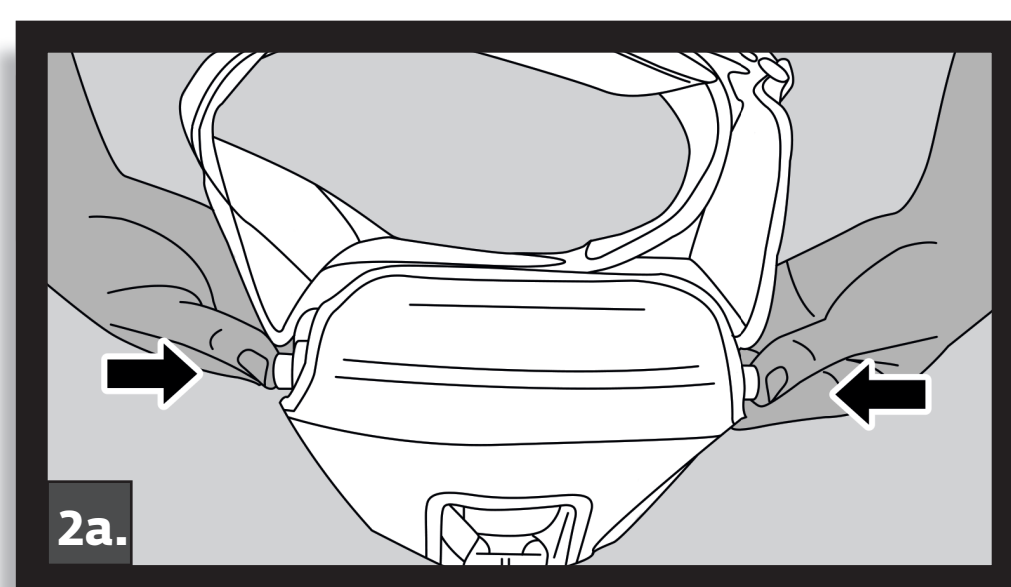

2b: While depressing IR/ER Button, Twist IR/ER Dial counter-clockwise until loose enough to:

IR/ER: Rotate arm brace to appropriate angle. Retighten Dial.

SHOULDER HEIGHT: Move arm brace up or down panel until appropriate position is achieved. Retighten Dial.

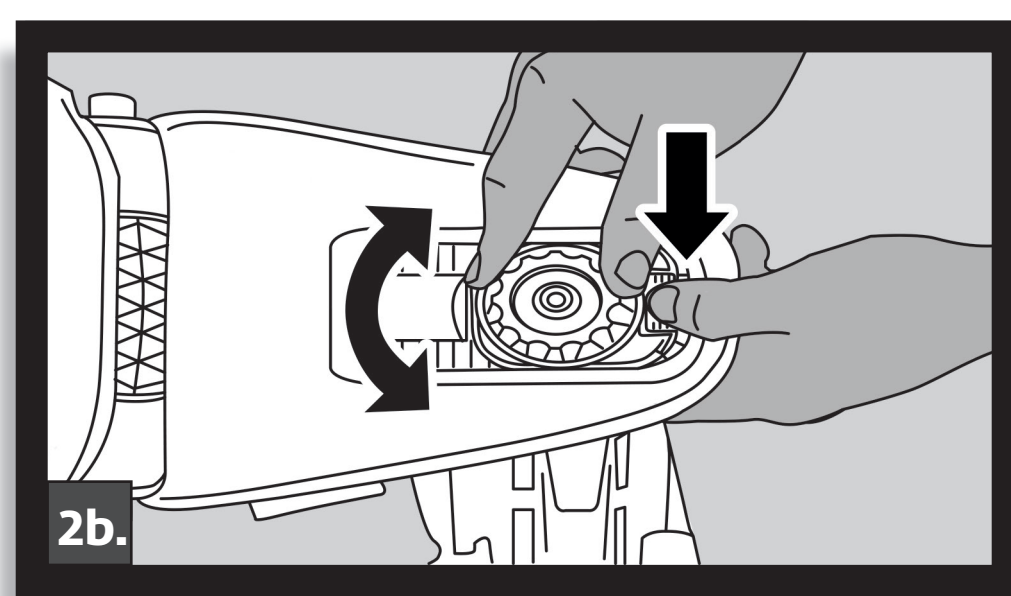

3b: To secure arm brace, adhere Bicep Strap. To tighten, pull bicep adjustment strap across bicep. Repeat for Forearm and Hand Straps.

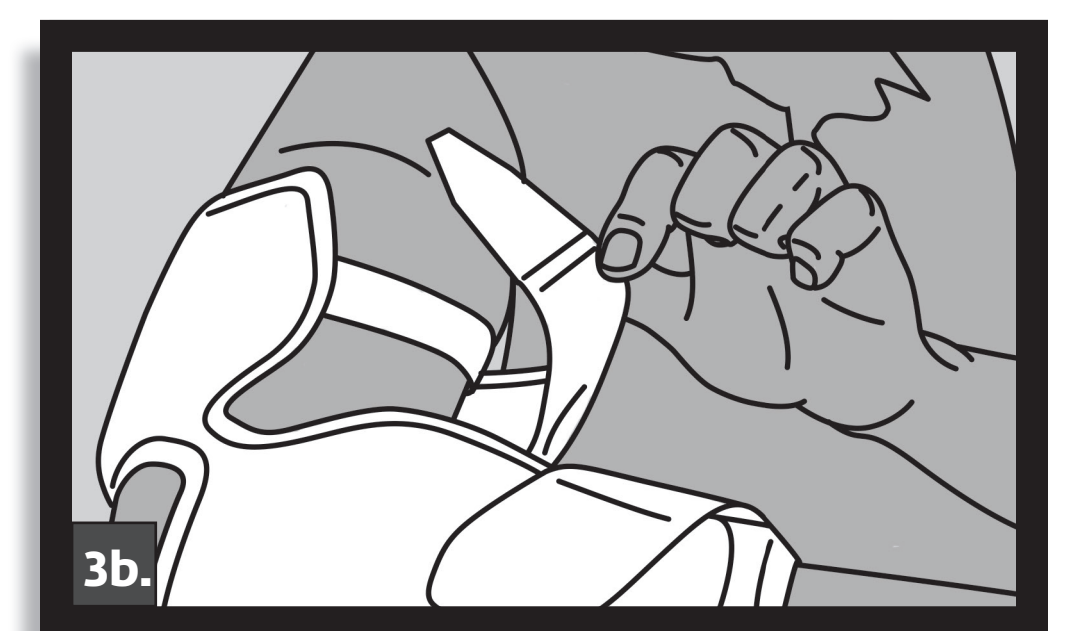

3c: Extend Hand Support to achieve proper hand position and support. For a more comfortable fit, bend lower portion of Hand Support to fit lower palm.

Note: Apply optional Wrist Pad, if needed.

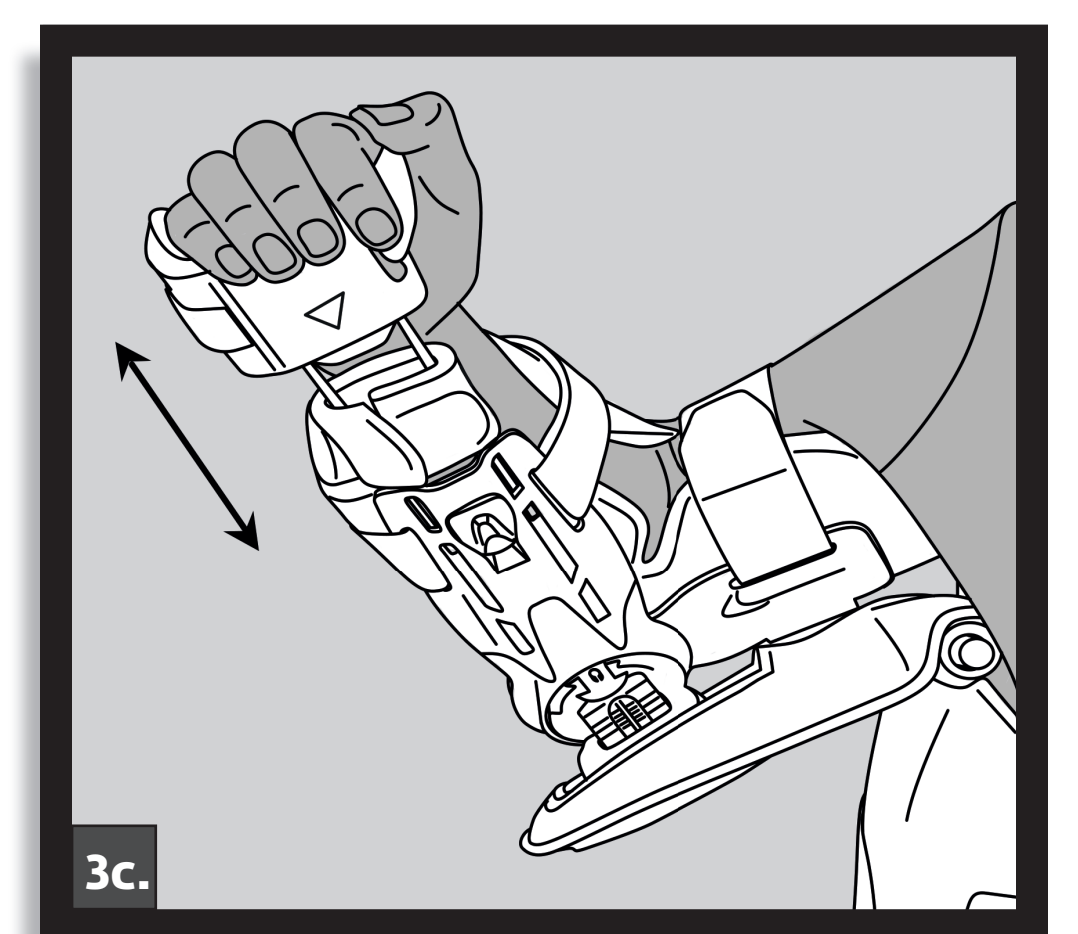

Brace Removal

Detach the three arm straps followed by the belt closure. Remove brace.

Optional Armsling Strap

Adhere strap end with buckle onto front of Waist Belt above Belt Closure. Secure remaining strap end to rear opposite side of Waist Belt.

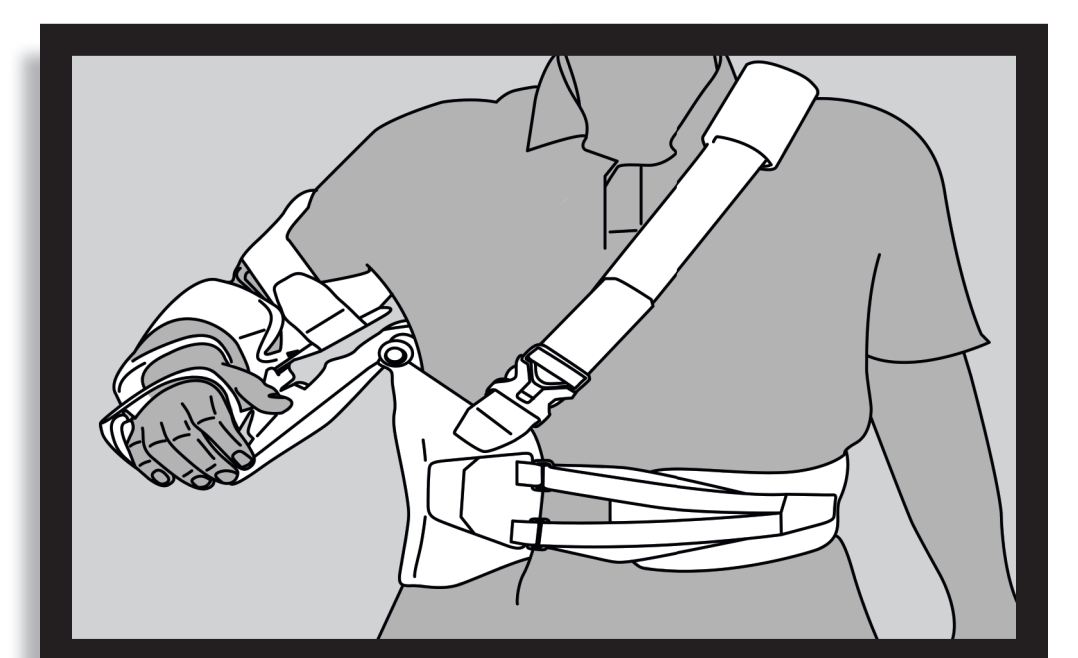

For more information including application videos, please visit DJOglobal.com/donjoy/ultrasling-quadrant

USE AND CARE: Separate the rigid components from the soft goods prior to cleaning. Hand wash in water 86°F (30°C) using mild soap. Air dry.

MATERIAL CONTENTS: Nylon, Aluminum, Stainless Steel, Zinc coated steel wire, Copper, Nylon woven, Polyurethane Foam, Silicone, Epoxy, Polyurethane. **NOT MADE WITH NATURAL RUBBER LATEX.**

CONTRAINDICATIONS: None

For product assistance, please contact Product Support at **1.888.405.3251** or email product.specialist@djoglobal.com